



Weigh-In-Motion



Features :

- Applicable for occasions that have no high precision requirement, such as overload detection, logistics loading, construction site, mining area, good yard etc.
- Occupying small space.
- Static and dynamic dual-use.
- With a special designed cover for easy installation and maintenance.
- Load Cell : Protection IP 67.



Unmanned Indicator

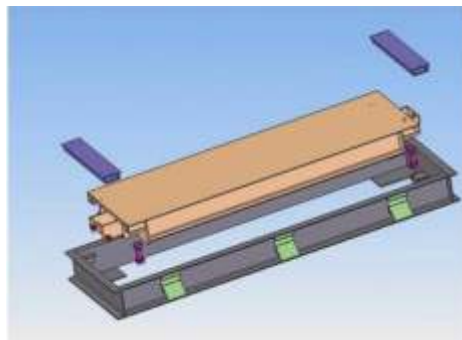

Optional :

- Unmanned weighing Indicator available.
- The testing system for overloading can be combined when the axle weigher equips with the light curtains, sensing loops, tyre discriminator, surveillance camera system and central control system.

WIM Vehicle Axle Weighbridge Scale

WIM Series

Model	WIM-30	WIM-50
Size (WxL)	3.0 x 0.8m	3.2m x 2.2m
Capacity Per Axle (T)	30 Ton	50 Ton
Total Weighing Cap.	100 Ton	120 Ton
Static Precision	Class III	
Dynamic Precision	Higher than 1/200	
Safe Overload	150% F.S.	
Weighing Speed	≤ 5km/h	
Power	AC and DC power supply	

Specification are subject to change without prior notice. Images shown are for illustrations purpose only.