

# Wheelchair Scale

CTG-CS Series

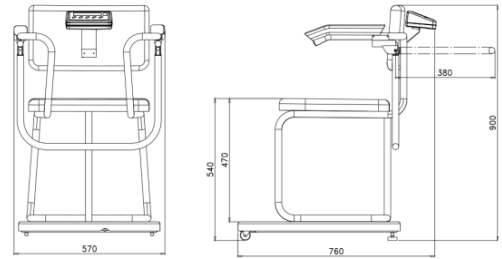

Wheelchair Scale designed for weighing patients in sitting position. Each scales is equipped with moveable wheels for fast and easy transport of scale to operation place. Chair scale is equipped with backlit LCD / LED display. It is powered either from mains or from batteries. Such solution allows for taking measurements no matter on place of operation and access to power supply.

## Applications

- Families
- Hospitals
- Clinics

## Approval :

- Models Approved by Legal Metrology (WM). Govt. of India.
- BIS Certified ISI - 7800029512
- ISO 9001: 2015
- ISO 13485 : 2016

• Conforming to :- IS: 9281 (Part 1&2) / 1979, IS: 9281 (Part - 3) / 1981, IS: 9281 (Part - 4) / 1983 (Reaffirmed 2006)

Model	CTG 150CS
Capacity (kg / lbs)	150 / 330
Readability (g)	100
Tare Range (kg)	-150
Working Temperature	0° to + 40°C
Output Signal	RS 232(Optional)
Power Supply	230V AC, 50Hz / 11V AC i6xR6
Display	LCD ( with Backlight)
Net weight (kg)	25
Gross weight (kg)	35
Packing Size(L x W x H) (mm)	770 x 620 x 1040